

NOTES:

1. SUBSTRATE MATERIAL:
FUSED SILICA

2. SURFACE S2 TO BE PARALLEL TO SURFACE S1 TO WITHIN <3 ARCMIN

3. COATING (APPLY ACROSS CLEAR APERTURE)

S1: DIELECTRIC

Rs(AVG) ≥ 99.90% @ 800nm & 1030nm @ 45° AOI

Rp(AVG) ≥ 99.90% @ 800nm & 1030nm @ 45° AOI

R(AVG) ≥ 99.6% @ 760 – 840nm @ 45° AOI

R(AVG) ≥ 99.6% @ 980 – 1080nm @ 45° AOI

S2: NONE

4. FINE GRIND SURFACE

5. POWER, IRREGULARITY, SURFACE QUALITY, AND COATING SPECIFICATIONS APPLY ACROSS CLEAR APERTURE

6. ROHS COMPLIANT

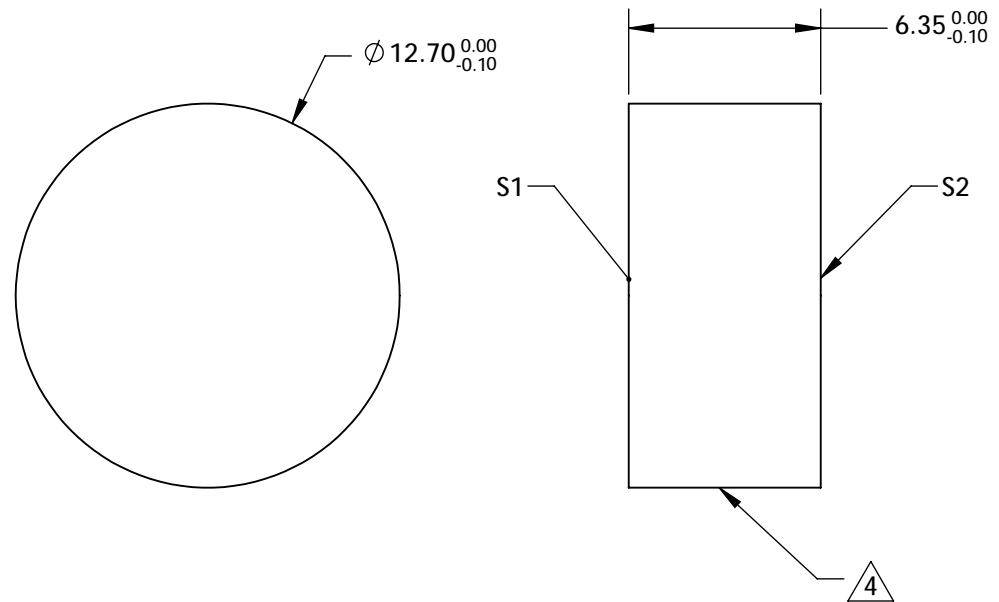
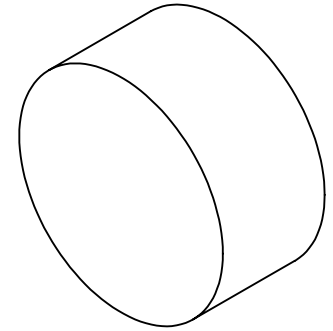

**FOR INFORMATION ONLY:
DO NOT MANUFACTURE
PARTS TO THIS DRAWING**

SPECIFICATIONS SUBJECT TO CHANGE WITHOUT NOTICE
DIMENSIONS ARE FOR REFERENCE ONLY

	S1	S2
SHAPE	PLANO	PLANO
SURFACE FLATNESS	$\lambda/10$	N/A
SURFACE QUALITY	10 - 5	COMMERCIAL POLISH
CLEAR APERTURE	$\phi 11.43$	N/A
BEVEL	PROTECTED AS NEEDED	PROTECTED AS NEEDED

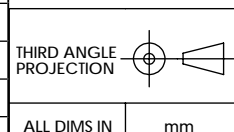

EO® Edmund Optics®

TITLE	12.7mm Dia. x 6.35mm 800/1030nm, Dual Band Laser Mirror	
DWG NO	28965	SHEET 1 OF 3

ALL DIMS IN mm