

NOTES:

1. SUBSTRATE: N-BK7
2. S2 TO BE PARALLEL WITH S1 TO <1 ARCMIN
3. COATING (APPLY ACROSS CLEAR APERTURE)

S1: NIR I (600-1050nm)
 S2: NIR I (600-1050nm)
 Ravg ≤0.5% @ 600 - 1050nm

4. FINE GRIND SURFACE

5. ROHS COMPLIANT

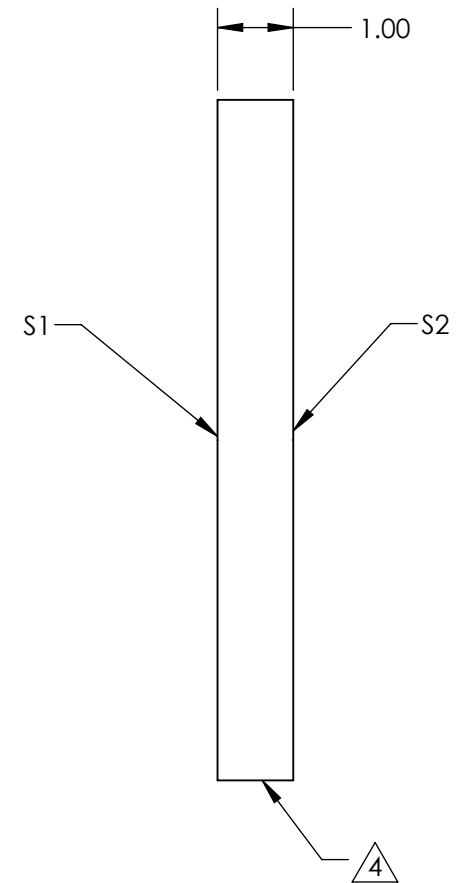
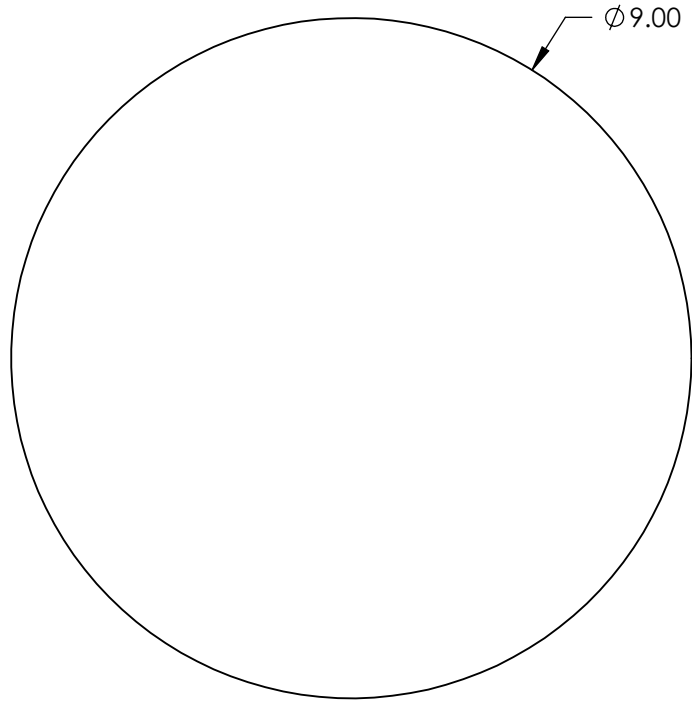
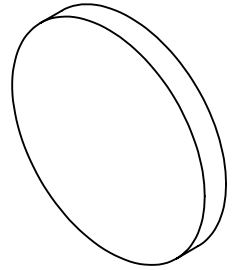

**FOR INFORMATION ONLY:
 DO NOT MANUFACTURE
 PARTS TO THIS DRAWING**

SPECIFICATIONS SUBJECT TO CHANGE WITHOUT NOTICE
 DIMENSIONS ARE FOR REFERENCE ONLY

	S1	S2
SHAPE	PLANO	PLANO
SURFACE QUALITY	60-40	60-40
CLEAR APERTURE	Ø8.10	Ø8.10
BEVEL	PROTECTED AS NEEDED	PROTECTED AS NEEDED



ALL DIMS IN mm

EO® Edmund Optics®

TITLE: 9mm Dia., 1mm Thick, NIR I Coated λ/4 N-BK7 Window

DWG NO: 23422 SHEET 44 OF 84